

31 Jefferson 117 Nell Lane, West Didsbury, Manchester, M20 2DU





 3  2  2  D

VIDEO TOUR AVAILABLE A unique, THREE BEDROOM, duplex apartment. Situated across the third and top floor of this purpose-built development in West Didsbury known as Jefferson apartments.

A short stroll from Burton Road with its array of independent boutique shops, popular bars, restaurants and cafes and the Metrolink stations on The Parkway, Withington or Lapwing Lane, West Didsbury, providing direct access into the city centre, Media City and Didsbury Village.

In brief the well planned apartment consists of; an entrance hall with useful storage cupboards, a W.C, two double bedrooms both benefitting from en-suites, an additional bedroom, and an open plan newly fitted kitchen/ living room. The kitchen benefits from a central island and access out onto the private balcony. The kitchen and en-suite both benefit from underfloor heating.

Stairs leading to the first floor reveals a study, and a sizeable lounge with access out onto the impressive private terrace area with sweeping sky line views.

The apartment benefits from electric heating, under floor heating, an intercom system, two private outdoor areas, and an allocated parking space.

£580,000





EPC Chart

Energy Efficiency Rating		Current	Potential
Very energy efficient - lower running costs			
(92 plus) A			
(81-91) B			
(69-80) C			76
(55-68) D		55	
(39-54) E			
(21-38) F			
(1-20) G			
Not energy efficient - higher running costs			
England & Wales		EU Directive 2002/91/EC 	



Tenure: Leasehold Council Tax Band: F

Third Floor

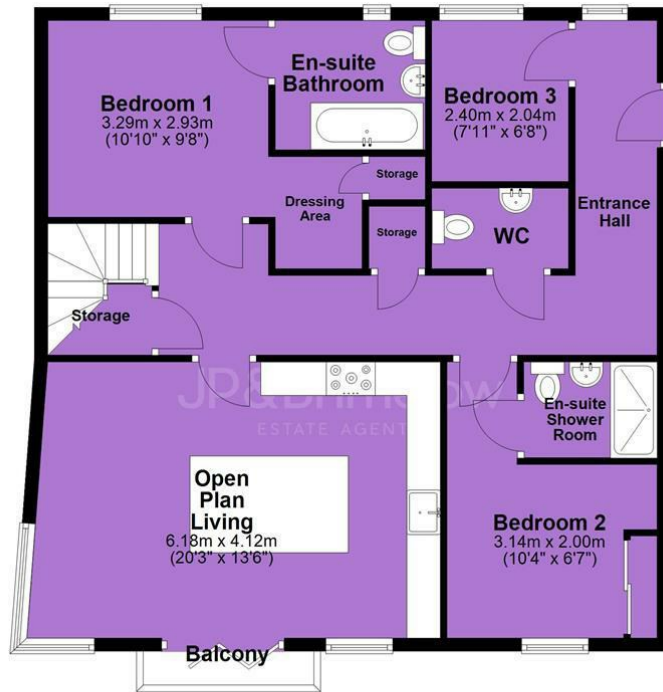

Top Floor



JP & Brimelow Estate Agents Ltd
430 Barlow Moor Road, Manchester, M21 8AD
Tel: 0161 8822233
E: sales@jpbrimelow.co.uk www.jpandbrimelow.co.uk



JP & Brimelow
ESTATE AGENTS

NOTICE: JP & Brimelow Estate Agents Ltd for themselves and for the vendors or lessors of this property whose agents they are give notice that:

- (i) the particulars are set out as a general outline only for the guidance of intending purchasers or lessees, and do not constitute, nor constitute part of, an offer or contract;
- (ii) all descriptions, dimensions, references to the condition and necessary permissions for use and occupation, and other details are given in good faith and are believed to be correct but any intending purchasers or tenants should not rely on them as statements or representations of fact but must satisfy themselves by inspection or otherwise as to the correctness of each of them;
- (iii) no person in the employment of JP & Brimelow Estate Agents Ltd has any authority to make or give any representation or warranty whatever in relation to this property.

jpandbrimelowstateagents

@jpandbrimelow

